



Town of Southern Pines
Soil Erosion and Sedimentation Control – Compliance Form

Tracts Less than Thirty-Thousand Square Feet (30,000 SF) Residential and Commercial
 and Not Part of a Larger Common Plan of Development

This compliance form shall be prominently displayed at the primary entrance to the site of the land disturbing activity
 Before construction begins and remain until construction is complete.

PROPERTY ADDRESS: _____ PIN: _____

NAME OF SUBDIVISION: _____ LOT #: _____

NAME OF PROPERTY OWNER: _____

ADDRESS OF PROPERTY OWNER: _____

NAME OF CONSTRUCTION COMPANY: _____

NAME OF CONSTRUCTION MANAGER: _____

COMPANY TELEPHONE: _____ Email: _____

PROPOSED START DATE OF CONSTRUCTION: _____

| | |
|--|------------------------------------|
| <p>PLEASE READ THE BACK SIDE BEFORE COMPLETING.</p> <p>Choose one of the following approaches:</p> <p><input type="checkbox"/> The most appropriate option from the back of this form is option _____ or a combination of options _____ and _____.</p> <p>The sediment control plan is as drawn in the space to the right or is attached.</p> | <p>EROSION CONTROL PLAN</p> |
| <p>Describe the purpose of the proposed construction activity</p> | |

THE UNDERSIGNED HEREBY CERTIFIES THAT HE/SHE HAS READ THE INFORMATION ON THE BACK OF THIS FORM AND IS AWARE OF THE STATED REQUIREMENTS OF THE SOIL EROSION AND SEDIMENTATION CONTROL CHAPTER. THE OWNER MUST COMPLY WITH THE PROVISIONS OF THE CHAPTER.

Erosion Control Compliance approval does not grant permission to remove ANY TREES with-in street right of ways of the TOWN. Contact the ToSP Building and Grounds Dept. at 910-692-4863 for removal procedures of trees within the R-O-W. Property Owner is to contact US Fish and Wildlife Services at 910-695-3323 to determine compliance with all rules and regulations regarding Red-cockaded Woodpeckers.

PROPERTY OWNER'S SIGNATURE PRINT NAME Date

FOR OFFICE USE ONLY:

Exempt from installation of ESC measures. **REASON:** _____

An Erosion Control Plan Approval is required. **REASON:** _____

An Existing driveway will be used as the Temporary Construction Entrance.

A Town driveway permit is required to construct the proposed Temporary Construction Entrance.

Install Temporary Gravel Construction Entrance in accordance with Town detail attached and as indicated above

Install Silt Fencing in accordance with Town detail attached and as indicated above.

Call Town of Southern Pines Construction Inspector for compliance 48 hours prior to start of work for inspection of measures.

Groundcover on all slopes shall be established within 21 days of completion of any phase of construction. Upon completion of any phase of construction permanent groundcover shall be established within 15 working days or 90 calendar days; or 15 working days or 60 calendar days for property located within High Quality Water Zone.

Within a Red-cockaded Woodpecker cluster - Advise OWNERS to contact US Fish and Wildlife.



Soil Erosion and Sedimentation Control PLAN OPTIONS

The Town of Southern Pines Soil Erosion and Sedimentation Control Chapter requires that the minimum erosion control measures, as outlined in Section 154.07 (A), be installed when the disturbed area on a tract of land is less than thirty-thousand square feet (30,000 SF), *unless otherwise exempt from installation of measures/devices or ESC Plan Approval is required.* Furthermore, no person shall initiate any land-disturbing activity on a tract if more than thirty-thousand square feet (30,000 SF) is to be uncovered unless, thirty (30) days or more prior to initiating the activity; a Plan for such activity is filed with and approved by the Town. Failure to install and/or maintain erosion control measures/devices may result in penalties of up to \$5,000.00 per day.

INSTRUCTIONS:

Identify One or Any Combination of Letters for the Schematic That Best Describes the Erosion Control Measures That Will be Used at Your Site During Construction.

LEGEND:

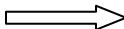
-  SILT FENCE
-  CONSTRUCTION ENTRANCE
-  DIRECTION OF FLOW (POINT DOWNHILL)

A. Flow to the Rear

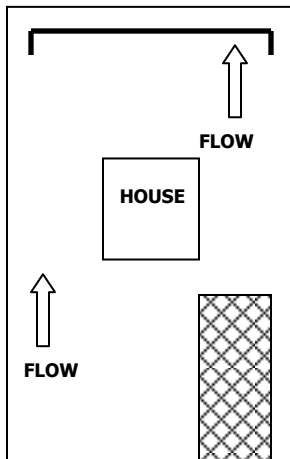

B. Flow to the Front

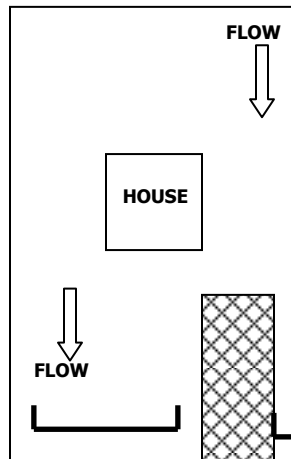

C. Flow to the Left

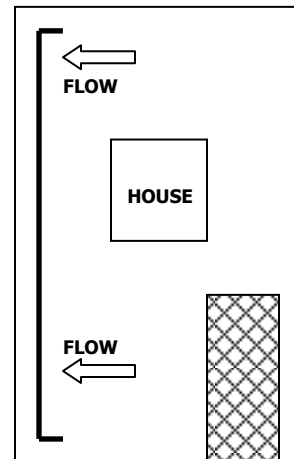

D. Flow to the Right

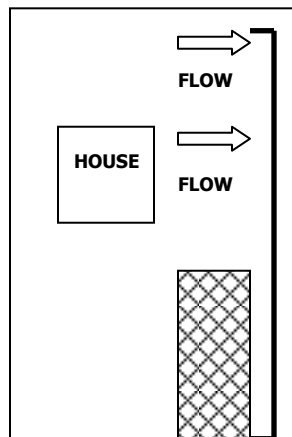

E. Flow to the Front & Rear

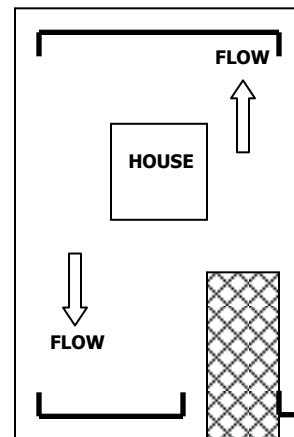



SOIL EROSION and SEDIMENTATION CONTROL

COMPLIANCE FORM

(Tracts less than thirty-thousand square feet (30000 SF) land disturbance) Residential and Commercial
Not Part of a Larger Common Plan of Development

(A) Minimum Erosion Control Measures Required, Unless Otherwise Approved.

The approved and minimum required erosion control measures to be placed on an individual residential or commercial construction site that is less than thirty-thousand square feet (30,000 SF) in surface area are:

- (1) A construction entrance,
- (2) Silt fencing on all lower elevation perimeters, and
- (3) Established groundcover.

The site must comply with the Town's Soil Erosion and Sedimentation Control Chapter by installing and maintaining all required controls measures as indicated on permit approval.

The only land disturbing activity to take place before the erosion control measures are completed is the cutting of trees and/or vegetation necessary to install the erosion control measures and/or devices.

If it is determined that: a significant risk of accelerated erosion exist; off-site sedimentation may occur as a result of the land-disturbing activity; and/or other conditions exist that require the preparation and approval of a Plan and that a grading permit be secured for land-disturbing activity of areas less than thirty-thousand square feet (30,000 SF), the Compliance Form is not valid.

(B) Compliance Procedure.

The property owner shall notify the Town of Southern Pines Construction Inspector to schedule an inspection of the ESC measures required. If the erosion control measures are not installed by the scheduled footing inspection and/or the Construction Inspector observes any erosion control problems on the site, including, but not limited to, failure to install erosion control measures, a written Notice of Violation will be issued in accordance with Section 154.17 (C). The footing inspection or any subsequent inspection approval will not be rendered until all control measures are in place and functioning.

(C) Final Inspections.

When all construction on the project is complete, call the Construction Inspector to schedule an inspection. The inspection will evaluate the site and all permanent erosion control features and off-site impacts to other properties, if applicable. If found to be in compliance, the Building Inspector will be advised, giving approval for the Certificate of Occupancy.

A Soil Erosion and Sedimentation Control Compliance Form, indicating the minimum control measures to be installed at the site, must be completed before a building permit can be issued, unless otherwise approved.

APPROVAL PROCESS:

- 1. Obtain an ESC Compliance Form, along with other application forms such as Water and/or Sewer Service and Driveway Permit, at Town offices or web site www.southernpines.net.
- 2. Complete and submit to the Town through the On-line Permitting Portal.
- 3. The Public Works Department will review / approve / comment on the application.
- 4. The approved ESC Compliance Form will be returned to the applicant or construction manager.
- 5. The Building Permit holder shall prominently display the approved ESC Compliance Form at the entrance to the construction site until the project is complete.
- 6. Attachments:
 - * ESC Compliance Form.
 - * Construction Details for installation of Temporary Construction Entrance & Temporary Silt Fence.

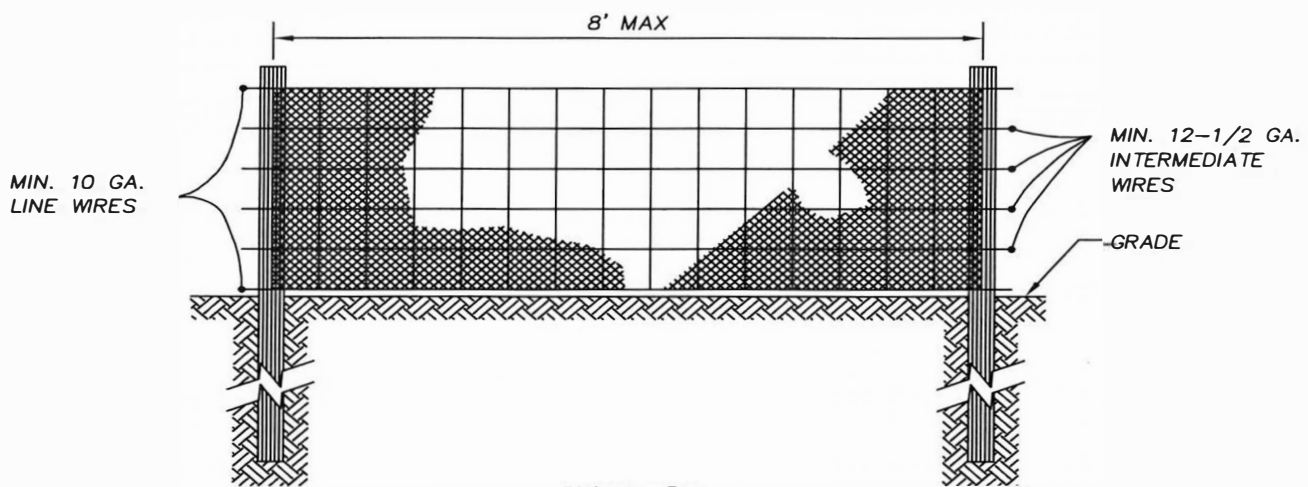

FRONT VIEW

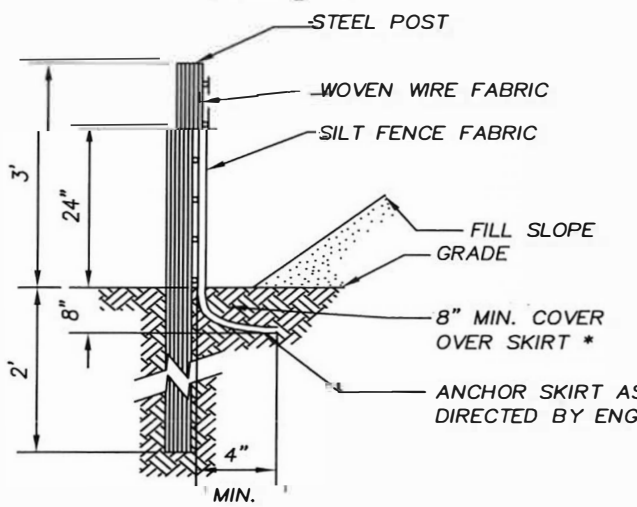

SIDE VIEW

NOTE:
USE SILT FENCE ONLY WHEN DRAINAGE AREA DOES NOT EXCEED 1/4 ACRE AND NEVER IN AREAS OF CONCENTRATED FLOW.

* FOR REPAIR OF SILT FENCE FAILURES, USE No. 57 WASHED STONE. FOR ANCHOR WHEN SILT FENCE IS PROTECTING CATCH BASIN.

NOTES & MAINTENANCE:

1. INSPECT SEDIMENT FENCES AT LEAST ONCE A WEEK AND AFTER EACH RAINFALL. MAKE ANY REQUIRED REPAIRS IMMEDIATELY.
2. SHOULD THE FABRIC OF A SEDIMENT FENCE COLLAPSE, TEAR, DECOMPOSE OR BECOME INEFFECTIVE, REPLACE IT PROMPTLY.
3. REMOVE SEDIMENT DEPOSITS AS NECESSARY TO PROVIDE ADEQUATE STORAGE VOLUME FOR THE NEXT RAIN AND REDUCE PRESSURE ON THE FENCE. TAKE CARE TO AVOID UNDERMINING THE FENCE DURING CLEANOUT.
4. REMOVE ALL FENCING MATERIALS AND UNSTABLE SEDIMENT DEPOSITS AND BRING THE AREA TO GRADE AND STABILIZE IT AFTER THE CONTRIBUTING DRAINAGE AREA HAS BEEN PROPERLY STABILIZED.
5. REMOVE SEDIMENT DEEPER THAN 12".

NOT TO SCALE

NOTES & MAINTENANCE:

1. ENTRANCE(S) SHALL BE LOCATED TO PROVIDE MAXIMUM UTILITY BY ALL CONSTRUCTION VEHICLES.
2. TURNING RADIUS SUFFICIENT TO ACCOMMODATE LARGE TRUCKS IS TO BE PROVIDED.
3. MUST BE MAINTAINED IN A CONDITION WHICH WILL PREVENT TRACKING OR DIRECT FLOW OF MUD ONTO STREETS. PERIODIC TOPDRESSING WITH 2" STONE WILL BE NECESSARY. CONTRACTOR SHALL MAINTAIN AS NECESSARY.
4. ANY MATERIAL WHICH STILL MAKES IT ONTO THE ROAD MUST BE CLEANED UP IMMEDIATELY.
5. FREQUENT CHECKS OF THE ENTRANCE(S) AND TIMELY MAINTENANCE SHALL BE PROVIDED.
6. NOTES ARE APPLICABLE AT ALL POINTS OF INGRESS AND EGRESS UNTIL SITE IS STABILIZED.

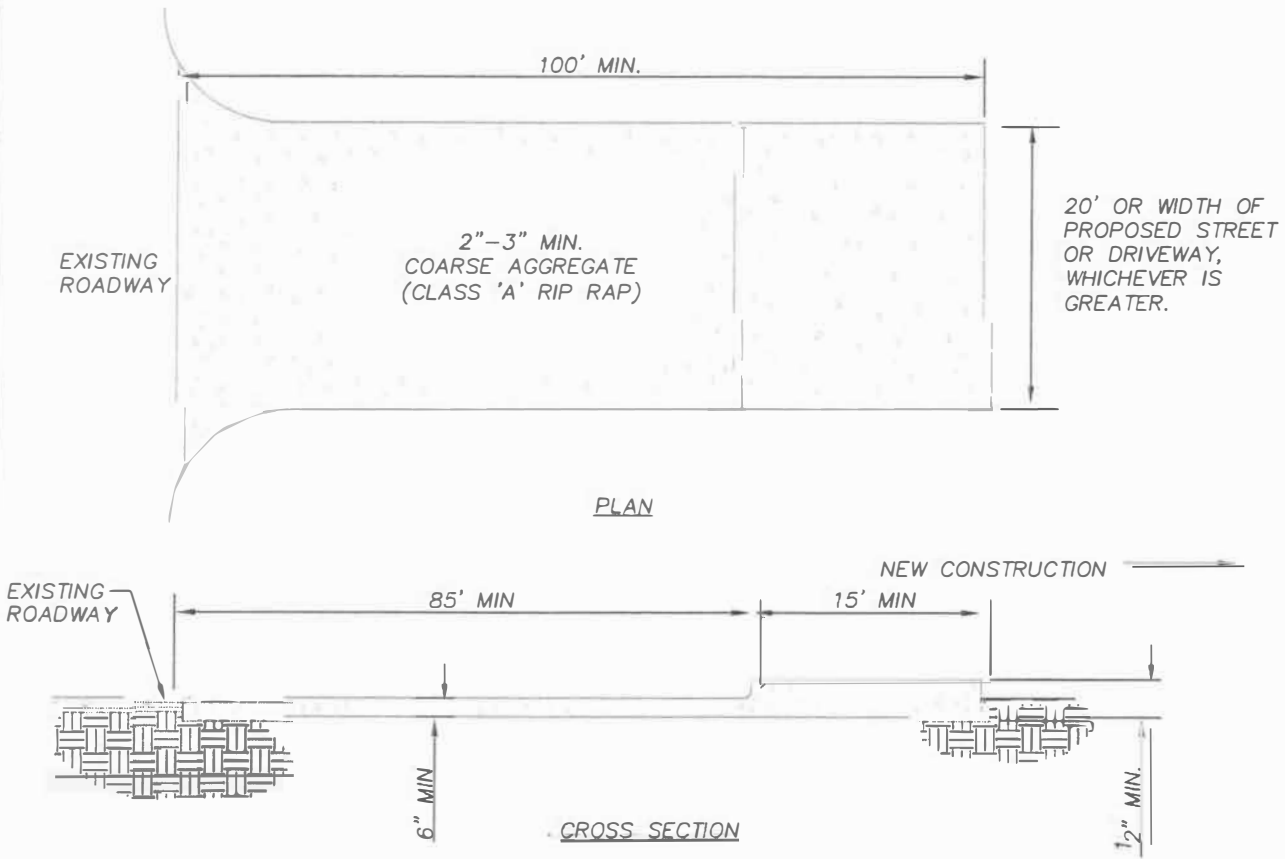

NOT TO SCALE

TOWN OF SOUTHERN PINES

DATE: JANUARY 2009

TEMPORARY GRAVEL CONSTRUCTION
ENTRANCE DETAIL

E-3